

Vision

Vision 1000/2000 - 20' Straight System

JS0909

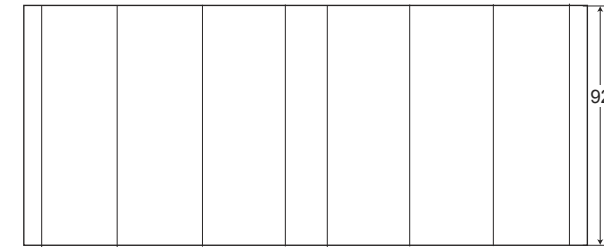
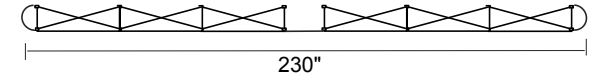
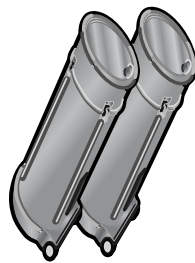
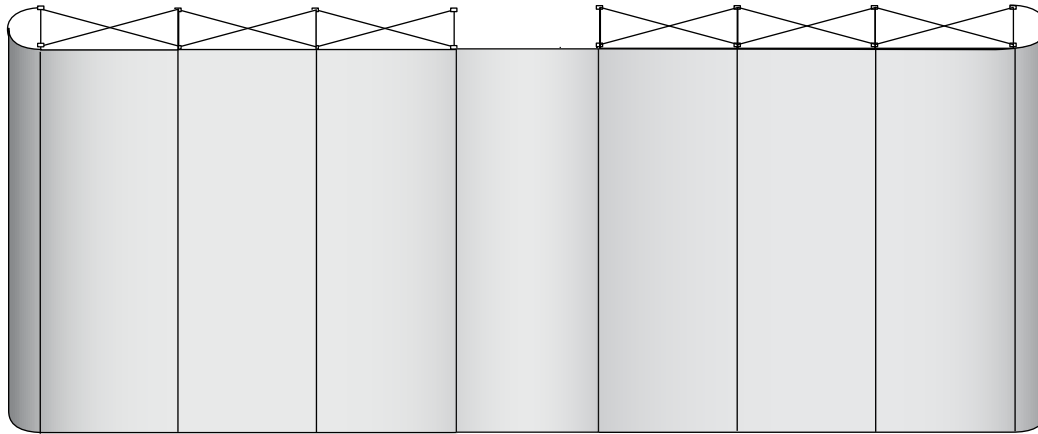

Plan View

US\$

Frame Package:

\$3,346.00

- 2 Straight Frames (2-9 Quads)
- 12 Folding Channel Bars
- 2 Oval Cases

Frame Package & End Caps:

\$3,923.00

- 2 Straight Frames (2-9 Quads)
- 12 Folding Channel Bars
- 4 Fabric Straight End Panels
- 2 Oval Cases

Complete System:

\$4,300.00

- 2 Straight Frames (2-9 Quads)
- 12 Folding Channel Bars
- 6 Fabric Straight Front Panels
- 4 Fabric Straight End Panels
- 2 Oval Cases

Popular Options

- Halogen Light Kit (2 - 200 W) \$295.00
- Halogen Spotlight (75 W) \$95.00
- Convertible Shelf Kit \$75.00
- Change to 4 Semi-Oval Cases + \$200.00

Complete System

& 2 Podium Conversion Kits

\$4,700.00

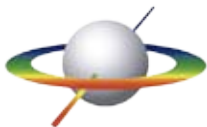

BENCHMARK IMAGING & DISPLAY
 640 BUSSE HWY., PARK RIDGE, IL 60068
 847.292.5150, FAX 847.292.5259
 WWW.BENCHMARKIMAGING.COM