

Vision

Vision 1000/2000 - 20' Curve Straight System

JCS1209

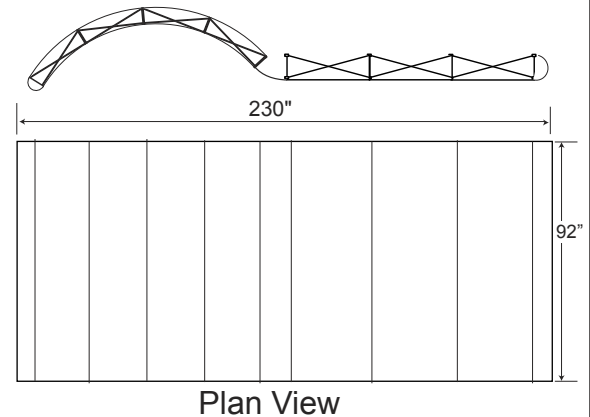
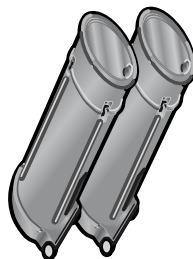
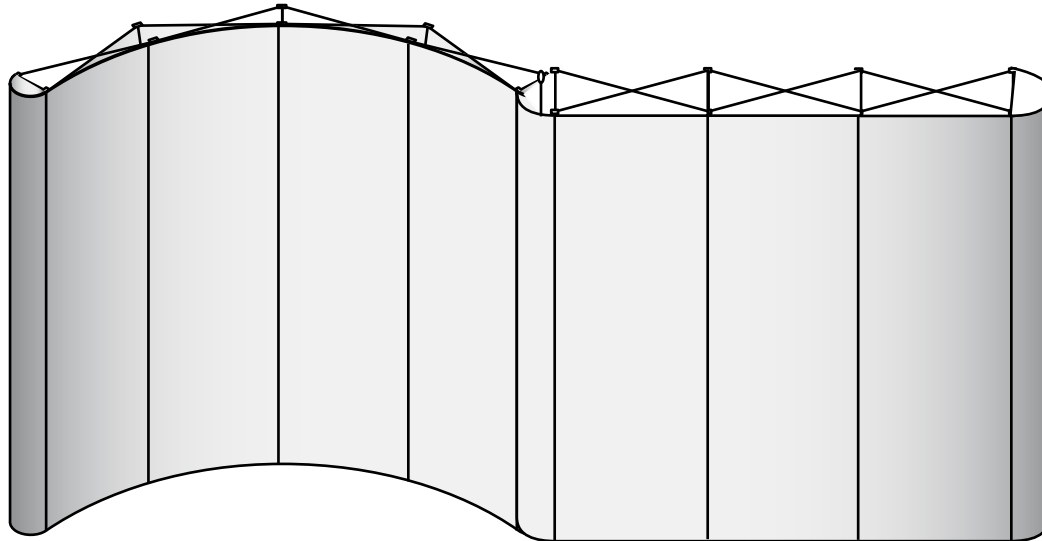

US\$

Frame Package:

\$3,528.00

- 1 Curve Frame (12 Quads)
- 1 Straight Frame (9 Quads)
- 13 Hinged Channel Bars
- 2 Oval Cases

Frame Package & End Caps:

\$4,073.00

- 1 Curve Frame (12 Quads)
- 1 Straight Frame (9 Quads)
- 13 Hinged Channel Bars
- 2 Fabric Curve End Panels
- 2 Fabric Straight End Panels
- 2 Oval Cases

Complete System:

\$4,645.00

- 1 Curve Frame (12 Quads)
- 1 Straight Frame (9 Quads)
- 13 Hinged Channel Bars
- 4 Fabric Curve Front Panels
- 3 Fabric Straight Front Panels
- 2 Fabric Curve End Panels
- 2 Fabric Straight End Panels
- 2 Oval Cases

**Complete System
& 2 Podium Conversion Kits**

\$5,045.00

Popular Options

- Halogen Light Kit (2 - 200W) \$295.00
- Halogen Spotlight (75W) \$95.00
- Convertible Shelf Kit \$75.00
- Backlit Header Kit with Lights \$350.00
- Change to 4 Semi-Oval Cases + \$200.00

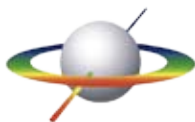

BENCHMARK IMAGING & DISPLAY
640 BUSSE HWY., PARK RIDGE, IL 60068
847.292.5150, FAX 847.292.5259
WWW.BENCHMARKIMAGING.COM